

Ratcheting Wrench

The SATA ratcheting wrench has the benefits of a ratchet and more.

- COMBINATION DOUBLE RATCHETING
- DOUBLE BOX
- REVERSIBLE
- FLEX HEAD
- XL LOCKING FLEX HEAD
- XL X-BEAM®

The strong fine gear ratcheting box end needs as little as 5° of sweep to move a fastener, and a standard fixed box end needs a minimum of 30° or 6 times the area.

The ultra small head shank design allows it into the tightest places, where a ratchet and socket will not fit. The ratcheting box end comes with Surface Drive® configuration that nearly eliminates fastener rounding. With the special accessory adapters, it becomes a fine gear ratchet that does not require special sockets.

All SATA ratcheting wrench products are designed and manufactured to the highest standards, with over 100 million units been "Professionally Tested" all over the world.

All SATA ratcheting wrenches are only available in mirror finished.

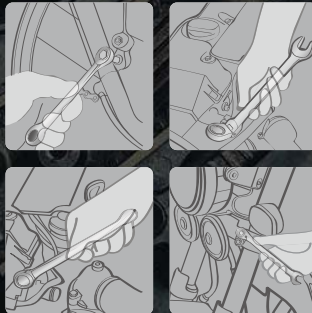

Ratcheting Wrench

Double Ratcheting Wrench - Combination

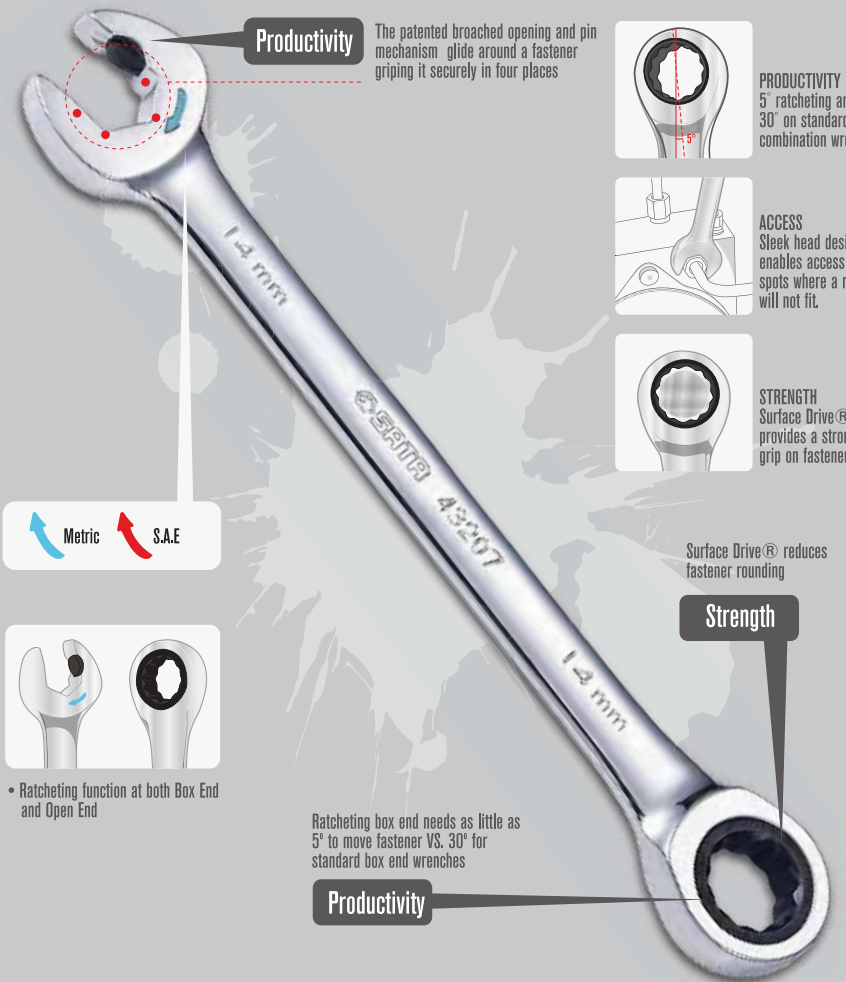

Productivity

The patented broached opening and pin mechanism glide around a fastener gripping it securely in four places



PRODUCTIVITY
5° ratcheting arc VS. 30° on standard combination wrenches.



ACCESS
Sleek head design enables access to tight spots where a ratchet will not fit.



STRENGTH
Surface Drive® provides a stronger grip on fasteners.

Metric S.A.E



• Ratcheting function at both Box End and Open End

Surface Drive® reduces fastener rounding

Strength

Ratcheting box end needs as little as 5° to move fastener VS. 30° for standard box end wrenches

Productivity

Ratcheting Wrench - XL X-Beam®

Ratcheting Wrench - Reversible

Access

- Up to 25% longer to access those hard to reach fasteners

Stronger

- Surface Drive Plus®
- Provides stronger grip on fasteners
- Reduces fastener rounding

Improved comfort

- Up to a 500% increase in surface contact area (vs. a standard handle wrench) to reduce hand fatigue

Strength

- Improved box end strength
- Surface Drive® reduces fastener rounding

ACCESS

The wider, super-strong crossbeam increases contact area with your hand by 500% over traditional wrenches.

STRENGTH

Surface Drive® provides a stronger grip on fasteners.

DESIGN

Forges at a 90-degree angle from the other end, and the tapered handle is thicker on both sides than a standard wrench.

Productivity

- Ratcheting box end needs as little as 5° to move fastener VS. 30° for standard box end wrenches

Productivity

- Compact reversing lever (no need to remove from fastener to change direction)

Access

- 15° offset provides additional knuckle clearance

Stronger

- Surface Drive® reduces fastener rounding

PRODUCTIVITY

Reversing lever allows you to switch motion from left to right without removing the wrench.

DESIGN

15° offset allows for safe operation above the work surface, providing additional knuckle clearance.

ACCESS

Sleek head design enables access to tight spots where a ratchet will not fit.

Ratcheting Wrench - Flex Head

Ratcheting Wrench - XL Locking Flex Head

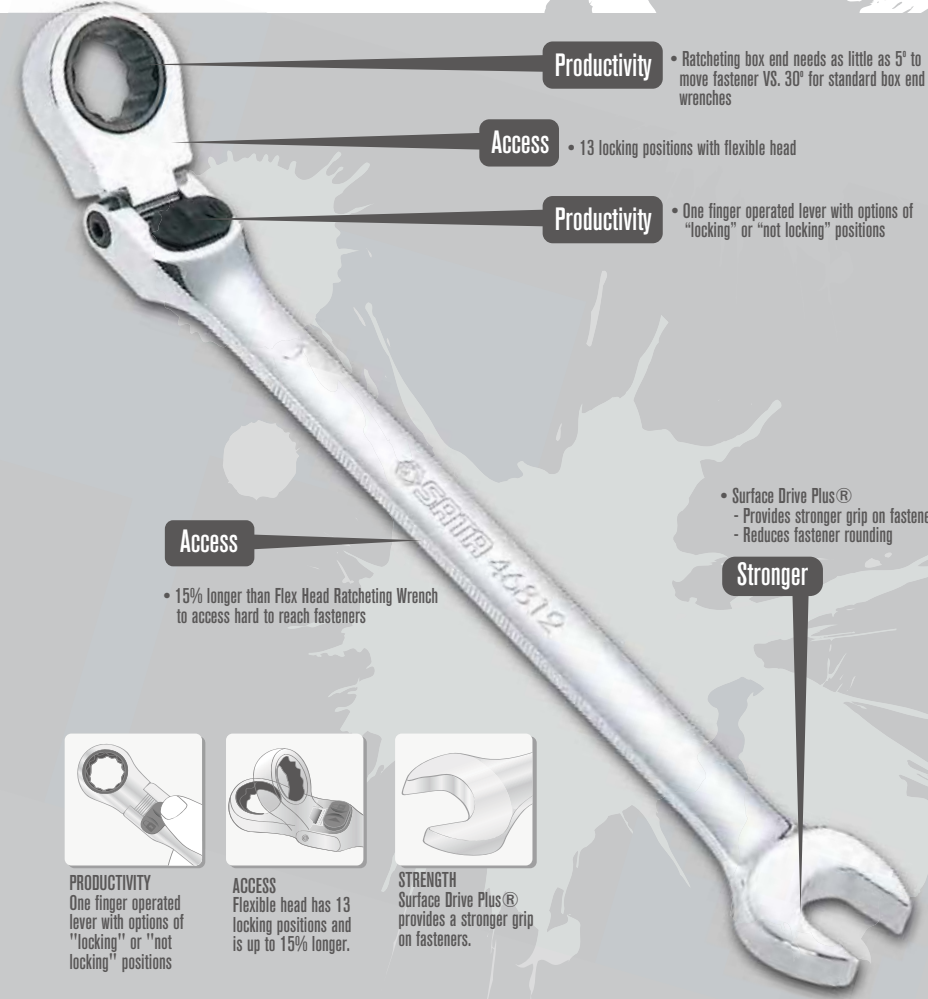
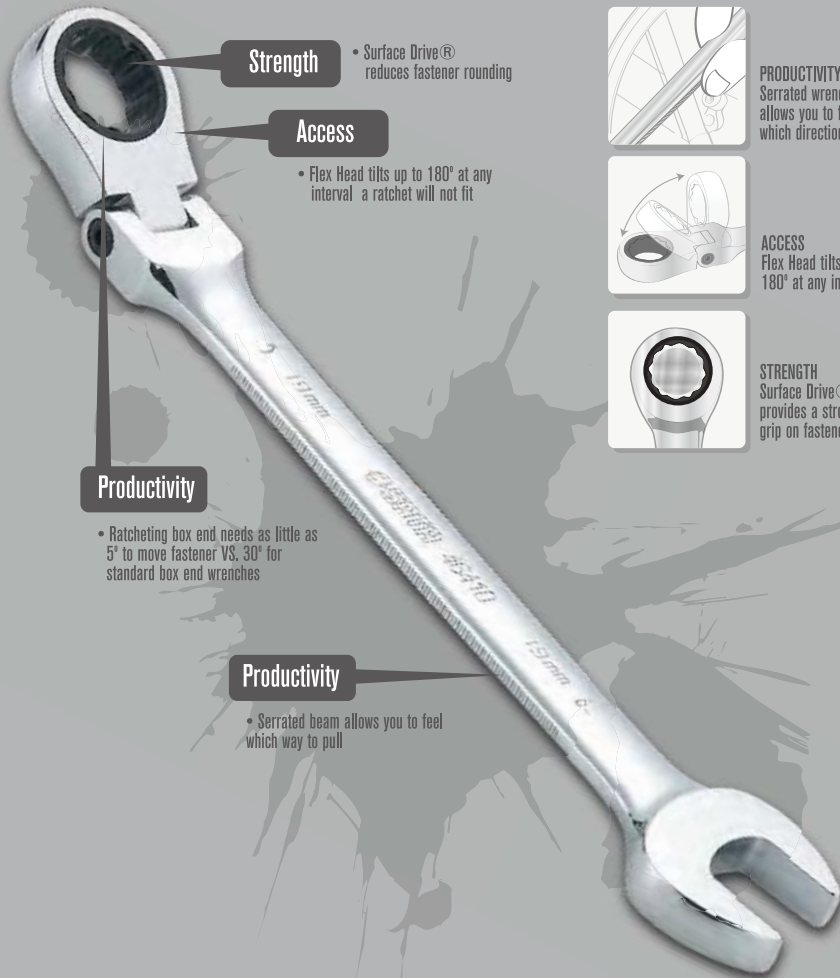

Strength

- Surface Drive® reduces fastener rounding

Access

- Flex Head tilts up to 180° at any interval a ratchet will not fit

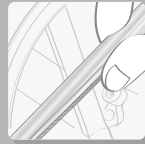

PRODUCTIVITY
Serrated wrench beam allows you to feel which direction to pull.



ACCESS
Flex Head tilts up to 180° at any interval.



STRENGTH
Surface Drive® provides a stronger grip on fasteners.

Productivity

- Ratcheting box end needs as little as 5° to move fastener VS. 30° for standard box end wrenches

Productivity

- Serrated beam allows you to feel which way to pull

Productivity

- Ratcheting box end needs as little as 5° to move fastener VS. 30° for standard box end wrenches

Access

- 13 locking positions with flexible head

Productivity

- One finger operated lever with options of "locking" or "not locking" positions

Access

- 15% longer than Flex Head Ratcheting Wrench to access hard to reach fasteners

Stronger

- Surface Drive Plus®
 - Provides stronger grip on fasteners
 - Reduces fastener rounding

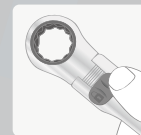

PRODUCTIVITY
One finger operated lever with options of "locking" or "not locking" positions



ACCESS
Flexible head has 13 locking positions and is up to 15% longer.



STRENGTH
Surface Drive Plus® provides a stronger grip on fasteners.

5 Pc. Metric Double Ratcheting Wrench Set

Cat. No.			G.W.
09078	0	12	10 kg

CONTENTS:
10, 11, 12, 13, 14 mm



7 Pc. SAE Double Ratcheting Wrench Set

Cat. No.			G.W.
08020	0	6	14.5 kg

CONTENTS:
5/16, 3/8, 7/16, 1/2, 9/16, 5/8, 3/4"



7 Pc. Metric Double Ratcheting Wrench Set

Cat. No.			G.W.
09050	0	5	9 kg

CONTENTS:
8, 10, 12, 14, 17, 19, 22 mm



8 Pc. Metric Double Ratcheting Wrench Set

Cat. No.			G.W.
08007A	0	12	12.2 kg

CONTENTS:
8, 10, 12, 13, 14, 15, 17, 19 mm



7 Pc. Metric Double Ratcheting Wrench Set

Cat. No.			G.W.
09024	0	6	14.5 kg

CONTENTS:
8, 10, 12, 13, 14, 15, 18mm



7 Pc. Metric Double Ratcheting Wrench Set

Cat. No.			G.W.
09054	1	4	8 kg

CONTENTS:
8, 10, 12, 14, 17, 19, 21 mm



8 Pc. Metric Double Ratcheting Wrench Set

Cat. No.			G.W.
09079	0	5	8.3 kg

CONTENTS:
8, 10, 11, 12, 13, 14, 17, 19mm



12 Pc. Metric Double Ratcheting Wrench Set

Cat. No.			G.W.
09066	2	4	9.2 kg

CONTENTS:
8, 9, 10, 11, 12, 13, 14, 15, 16, 17, 18, 19 mm



Ratcheting Wrench-Set

8 Pc. Metric XL X-Beam® Ratcheting Wrench Set

Cat. No.			G.W.
08015	0	4	7.6 kg

CONTENTS:
8, 10, 12, 13, 14, 15, 17, 19mm



10 Pc. Metric XL X-Beam® Ratcheting Wrench Set

Cat. No.			G.W.
08016	0	4	9.3 kg

CONTENTS:
8, 10, 12, 13, 14, 15, 16, 17, 18, 19mm



6 Pc. Metric Reversible Ratcheting Wrench Set

Cat. No.			G.W.
09080	0	5	6.6 kg

CONTENTS:
10, 12, 13, 14, 17, 19mm



5 Pc. Metric Flex Head Ratcheting Wrench Set

Cat. No.			G.W.
09082	0	12	11.2 kg

CONTENTS:
10, 11, 12, 13, 14mm



6 Pc. Metric Double Box Ratcheting Wrench Set

Cat. No.			G.W.
09025	0	6	7.8 kg

CONTENTS:
8x9, 10x11, 12x13, 14x15, 16x18, 17x19mm



5 Pc. Metric Reversible Ratcheting Wrench Set

Cat. No.			G.W.
09083	0	12	10.6 kg

CONTENTS:
10, 11, 12, 13, 14mm



7 Pc. Metric XL Locking Flex Head Ratcheting Wrench Set

Cat. No.			G.W.
09043	6	12	17.4 kg

CONTENTS:
10, 12, 13, 14, 15, 17, 19mm



3 Pc. Metric Drive Adapter Set

Cat. No.			G.W.
09084	10	40	6 kg

CONTENTS:
1/4"Dr. x 10mm
3/8"Dr. x 13mm
1/2"Dr. x 19mm





SAE Double Ratcheting Wrenches

Cat. No.	Fastener Size	End A Width	End B Width	Overall Length			G.W.
43501	5/16 in	20 mm	19 mm	140 mm	6	96	5.5 kg
43502	3/8 in	22.5 mm	21.4 mm	159 mm	6	96	7.1 kg
43503	7/16 in	25 mm	23 mm	165.5 mm	6	36	3.3 kg
43504	1/2 in	30 mm	26.5 mm	178 mm	6	36	4 kg
43505	9/16 in	32 mm	28.6 mm	191 mm	6	36	4.8 kg
43506	5/8 in	35 mm	32 mm	209 mm	6	36	5.9 kg
43507	11/16 in	38.5 mm	33.5 mm	226 mm	6	36	6.9 kg
43508	3/4 in	42 mm	37 mm	248 mm	6	36	8.8 kg
43509	13/16 in	46 mm	42 mm	292 mm	4	24	9.8 kg
43510	7/8 in	46 mm	42 mm	292 mm	4	24	9.8 kg
43511	15/16 in	52.2 mm	49 mm	334 mm	4	16	9.2 kg
43512	1 in	52.2 mm	49 mm	334 mm	4	16	9.3 kg
43113*	1-1/16 in	56.4 mm	52.5 mm	359 mm	4	16	12.2 kg
43114*	1-1/8 in	62 mm	58.5 mm	402 mm	2	12	10.5 kg
43115*	1-1/4 in	65.6 mm	62 mm	426 mm	2	12	14.1 kg

* These sizes are with standard (non-ratcheting) open end.

ASME B107.100-2010 (B10765)

Metric Double Ratcheting Wrenches

Cat. No.	Fastener Size	End A Width	End B Width	Overall Length			G.W.
43601	5.5 mm	15 mm	17.8 mm	126 mm	6	96	5.5 kg
43602	6 mm	15 mm	17.8 mm	126 mm	6	96	5.5 kg
43603	7 mm	17 mm	17.8 mm	133 mm	6	96	5.5 kg
43604	8 mm	20 mm	19 mm	140 mm	6	96	5.5 kg
43605	9 mm	20.3 mm	19.7 mm	150 mm	6	96	6 kg
43606	10 mm	22.5 mm	21.4 mm	159 mm	6	96	7.1 kg
43607	11 mm	25 mm	23 mm	165.5 mm	6	36	3.3 kg
43608	12 mm	27.4 mm	24.5 mm	172 mm	6	36	3.7 kg
43609	13 mm	30 mm	26.5 mm	178 mm	6	36	4 kg
43610	14 mm	32 mm	28.6 mm	191 mm	6	36	4.8 kg
43611	15 mm	34.5 mm	30 mm	200 mm	6	36	5.6 kg
43612	16 mm	35 mm	32 mm	209 mm	6	36	5.9 kg
43613	17 mm	38.5 mm	33.5 mm	226 mm	6	36	6.9 kg
43614	18 mm	40.5 mm	34.6 mm	237 mm	6	36	7.7 kg
43615	19 mm	43 mm	37 mm	248 mm	6	36	8.8 kg
43616	21 mm	46 mm	42 mm	292 mm	4	24	9.8 kg
43617	22 mm	46 mm	42 mm	292 mm	4	24	9.8 kg
43618	24 mm	52.2 mm	49 mm	334 mm	4	16	9.2 kg
43619	25 mm	52.2 mm	49 mm	334 mm	4	16	9.3 kg
43217*	27 mm	56.4 mm	52.5 mm	359 mm	4	16	12.2 kg
43218*	30 mm	62 mm	58.5 mm	402 mm	2	12	10.5 kg
43219*	32 mm	65.6 mm	62 mm	426 mm	2	12	12.2 kg

* These sizes are with standard (non-ratcheting) open end.

ASME B107.100-2010 (B10765)

- Sleek head design enables access to tight spots where a ratchet will not fit
- 5° ratcheting arc VS. 30° on standard combination wrenches
- Surface Drive® provides a stronger grip on fasteners

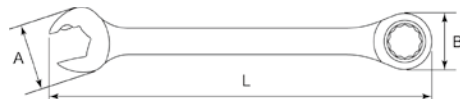

SAE XL X-Beam® Ratcheting Wrenches

Cat. No.	Fastener Size	End A Width	End B Width	Overall Length			G.W.
46321	5/16 in	20 mm	18.5 mm	151 mm	6	96	4.9 kg
46322	3/8 in	22.7 mm	22 mm	181 mm	6	96	7.4 kg
46323	7/16 in	25 mm	24 mm	196 mm	6	96	9.6 kg
46324	1/2 in	29 mm	27.4 mm	220.8 mm	6	72	9.6 kg
46325	9/16 in	32 mm	29 mm	235.8 mm	6	72	11.7 kg
46326	5/8 in	35 mm	33.3 mm	261 mm	6	36	7.7 kg
46327	11/16 in	38.5 mm	35 mm	276 mm	6	36	9.5 kg
46328	3/4 in	42 mm	37 mm	306 mm	6	36	12.6 kg

Metric XL X-Beam® Ratcheting Wrenches

Cat. No.	Fastener Size	End A Width	End B Width	Overall Length			G.W.
46301	8 mm	20 mm	18.5 mm	151 mm	6	96	4.9 kg
46302	9 mm	20.3 mm	19.6 mm	165 mm	6	96	6 kg
46303	10 mm	22.7 mm	22 mm	181 mm	6	96	7.4 kg
46304	11 mm	25 mm	24 mm	196 mm	6	96	9.6 kg
46305	12 mm	27 mm	25.3 mm	207.8 mm	6	96	11.1 kg
46306	13 mm	29 mm	27.4 mm	220.8 mm	6	72	9.6 kg
46307	14 mm	32 mm	29 mm	235.8 mm	6	72	11.7 kg
46308	15 mm	34 mm	31.3 mm	250 mm	6	72	13.4 kg
46309	16 mm	35 mm	33.3 mm	261 mm	6	36	7.7 kg
46310	17 mm	38.5 mm	35 mm	276 mm	6	36	9.5 kg
46311	18 mm	40.5 mm	36 mm	290 mm	6	36	10.3 kg
46312	19 mm	42 mm	37 mm	306 mm	6	36	12.6 kg

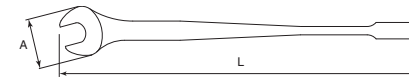

- Surface Drive® provides a stronger grip on fasteners and reduces fastener rounding
- Powerful - Torque output increase by 25%
- Up to a 500% increase on surface contact area (vs. a standard handle wrench) to reduce hand fatigue



SAE Double Box Ratcheting Wrenches

Cat. No.	Fastener Size	End A Width	End B Width	Overall Length			G.W.
46101	5/16x3/8 in	18.5 mm	21.8 mm	131 mm	6	36	2.7 kg
46102	7/16x1/2 in	23.5 mm	26.5 mm	161 mm	6	36	3.7 kg
46103	9/16x5/8 in	28.5 mm	32.5 mm	191 mm	6	36	5.7 kg
46104	1 1/16x3/4 in	34.5 mm	36.6 mm	231 mm	6	36	7.3 kg

ASME B107.100-2010 (B10765)

Metric Double Box Ratcheting Wrenches

Cat. No.	Fastener Size	End A Width	End B Width	Overall Length			G.W.
46201	8x9 mm	18 mm	19.5 mm	131 mm	6	96	5.9 kg
46200	8x10 mm	18.5 mm	21.8 mm	131 mm	6	96	6 kg
46202	10x11 mm	21.8 mm	23.5 mm	151 mm	6	36	3.2 kg
46203	12x13 mm	25 mm	26.5 mm	171 mm	6	36	4.1 kg
46204	14x15 mm	28.5 mm	30.5 mm	191 mm	6	36	5.7 kg
46205	16x18 mm	32.5 mm	35.5 mm	211 mm	6	36	6.3 kg
46206	17x19 mm	34.5 mm	36.6 mm	231 mm	6	36	7.3 kg

ASME B107.100-2010 (B10766)

- Sleek head design enables access to tight spots where a ratchet will not fit.
- 5° ratcheting arc VS. 30° on standard combination wrenches
- Surface Drive® provides a stronger grip on fasteners/Sleek head design enables access to tight spots where a ratchet will not fit.
- 5° ratcheting arc VS. 30° on standard combination wrenches
- Surface Drive® provides a stronger grip on fasteners

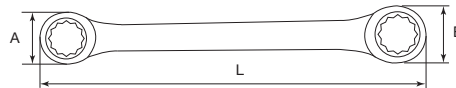

Metric Ratcheting Wrench Socket Adapters w/ Quick Release

Cat. No.	Male Drive Size	Overall Length			G.W.
46654	1/4"	20.3 mm	10	80	3.6 kg
46655	3/8"	24.3 mm	10	80	4.5 kg
46656	1/2"	29.3 mm	10	80	8 kg

- Fit into ratcheting wrench to become quick-release ratchet



SAE Reversible Ratcheting Wrenches

Cat. No.	Fastener Size	End A Width	End B Width	Overall Length			G.W.
46671	5/16 in	20 mm	18 mm	140 mm	6	36	2.1 kg
46672	11/32 in	20 mm	19.6 mm	150 mm	6	36	2.3 kg
46673	3/8 in	22.5 mm	21.6 mm	159 mm	6	36	2.6 kg
46674	7/16 in	25 mm	23.5 mm	165 mm	6	36	3.3 kg
46675	1/2 in	30 mm	27 mm	178 mm	6	36	4 kg
46676	9/16 in	32 mm	28.5 mm	191 mm	6	36	4.7 kg
46677	5/8 in	35 mm	33 mm	208 mm	6	60	9.4 kg
46678	11/16 in	38.5 mm	34.5 mm	226 mm	6	60	10.9 kg
46679	3/4 in	42 mm	37 mm	248 mm	6	60	12.6 kg
46680	13/16 in	46 mm	42 mm	292 mm	6	36	7.9 kg
46681	7/8 in	46 mm	42 mm	292 mm	6	36	7.9 kg
46682	15/16 in	52 mm	49 mm	334 mm	6	24	14.4 kg
46683	1 in	52 mm	49 mm	334 mm	6	24	14.4 kg

ASME B107.100-2010 (B10766)

Metric Reversible Ratcheting Wrenches

Cat. No.	Fastener Size	End A Width	End B Width	Overall Length			G.W.
46601	8 mm	20 mm	18 mm	140 mm	6	36	2.1 kg
46602	9 mm	20 mm	19.6 mm	150 mm	6	36	2.3 kg
46603	10 mm	22.5 mm	21.6 mm	159 mm	6	36	2.6 kg
46604	11 mm	25 mm	23.5 mm	165 mm	6	36	3.3 kg
46605	12 mm	27 mm	25 mm	172 mm	6	36	3.6 kg
46606	13 mm	30 mm	27 mm	178 mm	6	36	4 kg
46607	14 mm	32 mm	28.5 mm	191 mm	6	36	4.7 kg
46608	15 mm	34.5 mm	31 mm	200 mm	6	36	5.4 kg
46609	16 mm	35 mm	33 mm	208 mm	6	60	9.4 kg
46610	17 mm	38.5 mm	34.5 mm	226 mm	6	60	10.9 kg
46611	18 mm	41 mm	36 mm	236 mm	6	60	12 kg
46612	19 mm	42 mm	37 mm	248 mm	6	60	12.6 kg
46613	21 mm	46 mm	42 mm	292 mm	6	36	7.9 kg
46614	22 mm	46 mm	42 mm	292 mm	6	36	7.9 kg
46615	24 mm	52 mm	49 mm	334 mm	6	24	14.4 kg
46616	25 mm	52 mm	49 mm	334 mm	4	24	14.4 kg
46617	20 mm	46 mm	42 mm	292 mm	6	36	15 kg

ASME B107.100-2010 (B10766)

- Ratcheting box end needs as little as 5 degree to move fastener VS. 30 degree for standard box end wrenches
- Surface Drive® reduces fastener rounding
- 15 degree offset provides additional knuckle clearance
- Compact reversing lever (no need to remove from fastener to change direction)

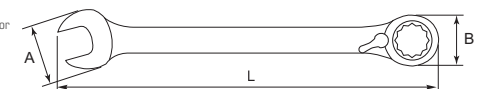



SAE Flex Head Ratcheting Wrenches

Cat. No.	Fastener Size	End A Width	End B Width	Overall Length			G.W.
46471	5/16 in	20 mm	18.5 mm	144 mm	6	36	2.5 kg
46472	3/8 in	22.5 mm	22 mm	161 mm	6	36	3.6 kg
46473	7/16 in	25 mm	24 mm	168 mm	6	36	4 kg
46474	1/2 in	30 mm	27.4 mm	181 mm	6	36	5.1 kg
46475	9/16 in	32 mm	28.8 mm	193 mm	6	36	6.2 kg
46476	5/8 in	35 mm	33 mm	210 mm	6	36	7.3 kg
46477	11/16 in	38.5 mm	35 mm	227 mm	6	36	8.5 kg
46478	3/4 in	42 mm	36.9 mm	249 mm	6	36	11.2 kg
46479	13/16 in	46 mm	42 mm	292 mm	6	36	18.5 kg
46480	7/8 in	46 mm	42 mm	292 mm	6	36	20.7 kg
46481	15/16 in	52.5 mm	49 mm	334 mm	4	24	15.6 kg
46482	1 in	52.5 mm	49 mm	334 mm	4	24	16.4 kg

ASME B107.100-2010 (B107.65)

SAE XL Locking Flex Head Ratcheting Wrenches

Cat. No.	Fastener Size	End A Width	End B Width	Overall Length			G.W.
46901	5/16 in	16.9 mm	17.9 mm	146 mm	6	72	4.6 kg
46902	11/32 in	18.8 mm	19.6 mm	159 mm	6	72	5.3 kg
46903	3/8 in	20.9 mm	21.3 mm	171 mm	6	72	6.7 kg
46904	7/16 in	23.1 mm	23 mm	183 mm	6	72	7.5 kg
46905	1/2 in	27.1 mm	26.2 mm	207 mm	6	72	10.4 kg
46906	9/16 in	29.3 mm	29.3 mm	219 mm	6	72	11.8 kg
46907	5/8 in	33.2 mm	31.7 mm	242 mm	6	36	9 kg
46908	11/16 in	35.5 mm	32.2 mm	254 mm	6	36	10 kg
46909	3/4 in	39.8 mm	36 mm	280 mm	6	36	12.5 kg
46910	13/16 in	45.9 mm	42 mm	316 mm	6	24	13.7 kg
46911	7/8 in	48.4 mm	42 mm	335 mm	6	24	13.7 kg
46912	15/16 in	51.9 mm	49 mm	356 mm	6	24	19 kg
46913	1 in	53.9 mm	49 mm	378 mm	6	24	19.2 kg

ASME B107.100-2010 (B107.65)

Metric Flex Head Ratcheting Wrenches

Cat. No.	Fastener Size	End A Width	End B Width	Overall Length			G.W.
46421	8 mm	20 mm	18.5 mm	144 mm	6	36	2.5 kg
46422	9 mm	20 mm	20 mm	152 mm	6	36	3.6 kg
46401	10 mm	22.5 mm	22 mm	161 mm	6	36	2.8 kg
46402	11 mm	25 mm	24 mm	168 mm	6	36	3.6 kg
46403	12 mm	27 mm	25 mm	174 mm	6	36	4.2 kg
46404	13 mm	30 mm	27.4 mm	181 mm	6	36	4.7 kg
46405	14 mm	32 mm	28.8 mm	193 mm	6	36	5.4 kg
46406	15 mm	34.5 mm	30.8 mm	202 mm	6	36	6.9 kg
46407	16 mm	35 mm	33 mm	210 mm	6	36	7.8 kg
46408	17 mm	38.5 mm	35 mm	227 mm	6	36	8.6 kg
46409	18 mm	41 mm	36 mm	238 mm	6	36	9.3 kg
46410	19 mm	42 mm	36.9 mm	249 mm	6	36	10.8 kg
46412	21 mm	46 mm	42 mm	292 mm	6	36	18.5 kg
46413	22 mm	46 mm	42 mm	292 mm	6	36	20.7 kg
46414	24 mm	52.5 mm	49 mm	334 mm	6	24	15.6 kg
46415	25 mm	52.5 mm	49 mm	334 mm	6	24	16.4 kg

ASME B107.100-2010 (B107.65)

Metric XL Locking Flex Head Ratcheting Wrenches

Cat. No.	Fastener Size	End A Width	End B Width	Overall Length			G.W.
46801	8 mm	16.9 mm	17.9 mm	146 mm	6	72	4.6 kg
46802	9 mm	18.8 mm	19.6 mm	159 mm	6	72	5.3 kg
46803	10 mm	20.9 mm	21.3 mm	171 mm	6	72	6.7 kg
46804	11 mm	23.1 mm	23 mm	183 mm	6	72	7.5 kg
46805	12 mm	25 mm	24.1 mm	195 mm	6	72	9.6 kg
46806	13 mm	27.1 mm	26.2 mm	207 mm	6	72	10.4 kg
46807	14 mm	29.3 mm	26.7 mm	219 mm	6	72	11.8 kg
46808	15 mm	31.2 mm	29.9 mm	231 mm	6	72	13.4 kg
46809	16 mm	33.2 mm	31.7 mm	242 mm	6	36	9 kg
46810	17 mm	35.5 mm	32.2 mm	254 mm	6	36	10 kg
46811	18 mm	37.5 mm	33.3 mm	267 mm	6	36	11 kg
46812	19 mm	39.8 mm	36 mm	280 mm	6	36	12.5 kg
46813	20 mm	45.9 mm	42 mm	297 mm	6	24	13.2 kg
46814	21 mm	45.9 mm	42 mm	316 mm	6	24	13.7 kg
46815	22 mm	48.4 mm	42 mm	335 mm	6	24	14.2 kg
46816	24 mm	51.9 mm	49 mm	356 mm	6	24	19 kg
46817	25 mm	53.9 mm	49 mm	378 mm	6	24	19.2 kg

ASME B107.100-2010 (B107.65)

- Serrated beam allows you to feel which way to pull
- Surface Drive® reduces fastener rounding
- Flex Head tilts up to 180 degree at any interval a ratchet will not fit.

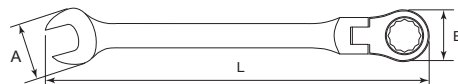

- 5° ratcheting arc VS. 30° on standard combination wrenches
- 13 locking positions with 180° flexible head
- One finger operated lever with options of "locking" or "not locking" positions
- Surface Drive® provides a stronger grip on fasteners

